

Chord Electronics
Product Communication | English

The Pumphouse, Farleigh Lane, East Farleigh, Kent,
ME16 9NB. Great Britain.
+44 (0) 1622 721 444
info@chordelectronics.co.uk
chordelectronics.co.uk

Suzi Manual

V1



Chord Electronics Ltd.

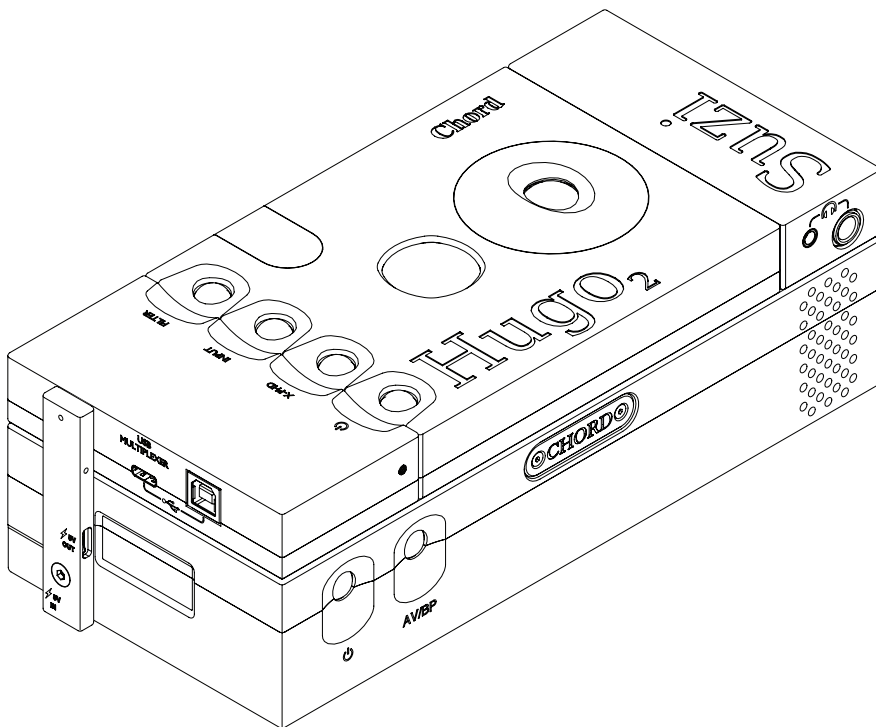

Made in
BRITAIN



1 Contents

Introduction	2
--------------	---

Support and warranty	3
----------------------	---

Connections and controls	4
--------------------------	---

Operation	5
-----------	---

Technical specifications	6
--------------------------	---

2 Introduction

The Suzi power amp is a highly configurable ULTIMA technology stereo power/amplifier. Its clever flexibility allows it to be arranged in a variety of ways to create adaptable playback solutions for a wide range of needs.

- The Suzi power amplifier can be arranged in four core configurations:
- The Suzi power amplifier with a pre-existing preamplifier
- The Suzi power amplifier with the Suzi Pre: analogue pre/power amplifier with phonostage
- The Suzi power amplifier with the Hugo 2 and USB multiplexer: DAC/digital pre/amplifier
- The Suzi power amplifier with the Hugo 2/2go: streaming DAC/digital pre/amplifier

Further operational details on the four configurations can be found in section 5.0 Operation.

2.1 Safety and care

- Do not allow the device to come into contact with water or liquids.
- Do not spray cleaning products onto the device. Use a clean microfibre cloth to clean the casework.
- A further safety document is included in the box.
- The device does not contain any user-serviceable components. Do not attempt to open, dismantle or apply internal third-party devices to it. Doing so will void the warranty.
- The unit benefits from casework heatsinking, however, always ensure the it is used in a well-ventilated setting, away from direct sunlight and heat sources, and has sufficient space around it.

3 Support and warranty

The Suzi power amp benefits from a three-year warranty covering defects in materials and workmanship through fair wear and tear



- Register your device online for the best aftersales support: www.chordelectronics.co.uk/register-product

In the unlikely event of a claim, contact your supplying dealer.

The warranty is transferable with proof of purchase, however, the warranty on ex-demonstration units begins from the retailer's date of purchase.

4 Connections and controls

4.1 Rear and front panels

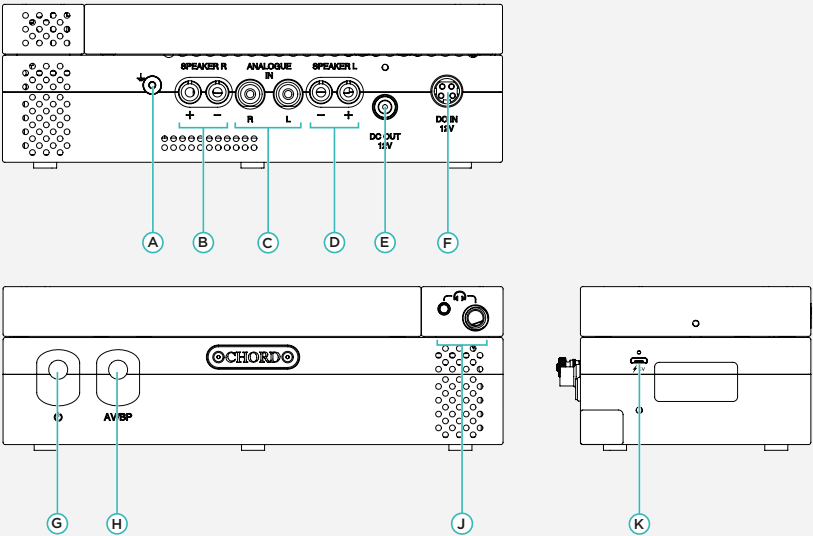

A	Grounding post	B	4 mm banana speaker outputs (R)	C	RCA analogue inputs (for use with existing preamps or only)
D	4 mm banana speaker outputs (L)	E	12 V power output	F	12 V power input
G	Power on/off	H	AV bypass (for Suzi Pre)	J	Headphone outputs: (when connected to Suzi Pre or Hugo 2) 1x 3.5 mm; 1x 6.35 mm (1/4 inch)
K	5 V Micro USB (for use with the charging bridge assembly, when used with the Hugo 2/USB multiplexer or the Hugo 2/2go)				

WARNING: Ensure all system devices are switched off and any volumes are set to zero before making any connections.

4.2 Remote control

NOTE: The remote will only work with a Chord Electronics unit such as the Suzi Pre

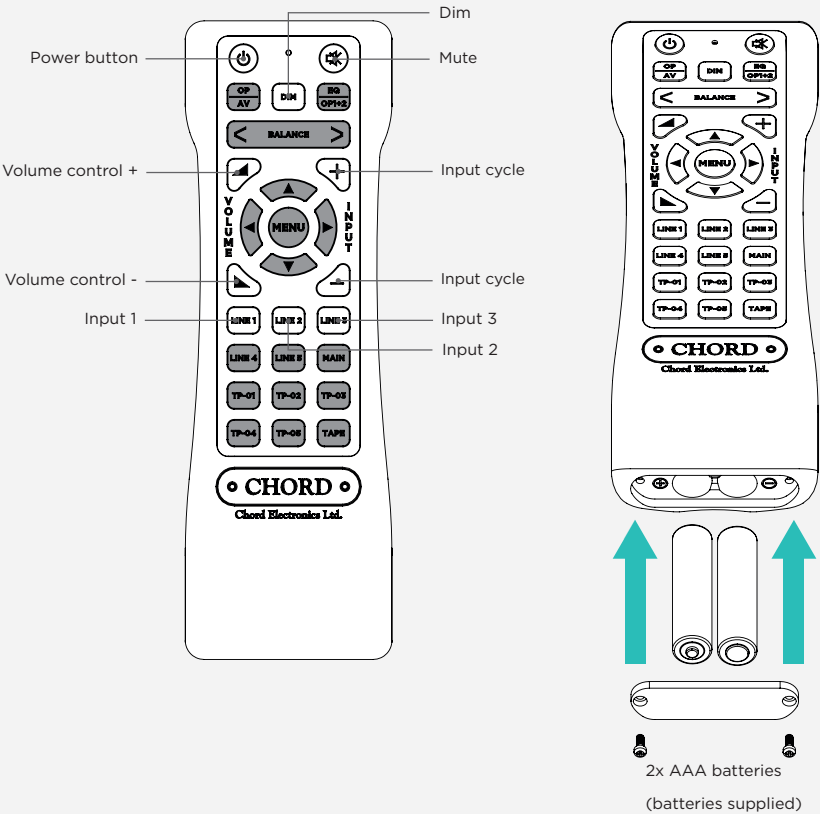

NOTE: Greyed buttons are not functional on the Suzi Pre

5 Operation

WARNING: Always set the volume to zero before switching on/playback and before connecting/removing headphones/speakers.

Below are individual instructions for using the Suzi power amp in the four core configuration options. Initial set up and operation is fundamentally identical, regardless of the core configuration.

With all equipment switched off, connect partnering equipment, such as preamps, loudspeakers or headphones, using the annotated drawings in section 4, Connections and controls, as a guide.

With partnering equipment connected, including the choice of preamp as outlined in sections 5.1-5.4 below, the power cable can now be connected and the unit switched on.

The power button displays red (standby). Press the power button to wake the unit from standby to on; the power button briefly displays green before settling on teal (for on); press the power button again to return the unit to standby (red).

The Suzi power amp uses very little power in standby mode and can be connected to power at all times.

5.1 The Suzi with a pre-existing preamplifier

The Suzi power amp is supplied as a standalone stereo power amplifier and a (removeable) pre-fitted cover block if supplied for this purpose.

To remove the block, unscrew the hex bolt at the far end of the cover block. Carefully lift the block while gently sliding it apart from the Suzi. Unscrew the attached grub screw from the Suzi, keeping them safe for reattachment.

In this configuration, follow the steps in section 4 Connections and Controls, to connect the unit to the chosen preamp via the RCA inputs, along with loudspeakers, and power.

NOTE: The AV/BP button will need to be pressed (displays blue) to select the Suzi power amp's rear RCA inputs. See **AV bypass feature** at the end of this section for details.

With all connections made, and all equipment powered on, press play on the chosen source and slowly raise the volume on the chosen preamp.

5.2 The Suzi power amp with the Suzi Pre: analogue pre/power amplifier

Adding the Suzi Pre transforms the Suzi power amp into an analogue pre/power amplifier with phonostage.

With all cables to the Suzi Pre and the Suzi power amp disconnected, carefully place the Suzi Pre atop the Suzi power amp, ensuring they are aligned, before gently sliding the Suzi Pre rightwards, to connect the Suzi Pre's (female) outputs to the Suzi power amp's (male) inputs.

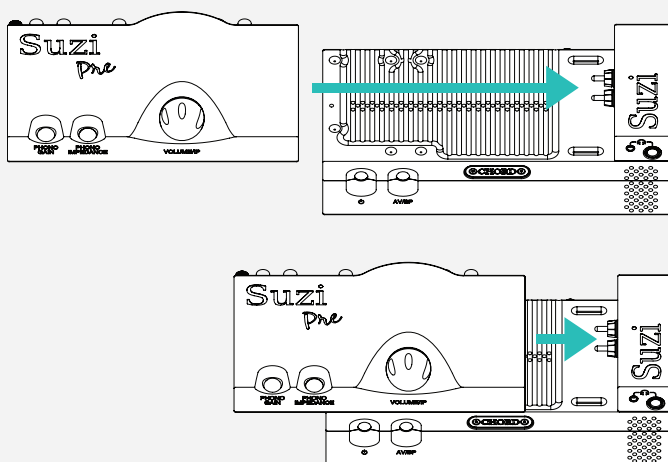

WARNING: Ensure the Suzi Pre's detachable headphone module has been removed before attempting to join the devices.

With the two units connected, secure them with the supplied locking plate. Attach the plate over the power input/output sockets on the rear panels and secure with the hex bolt, being careful not to overtighten.

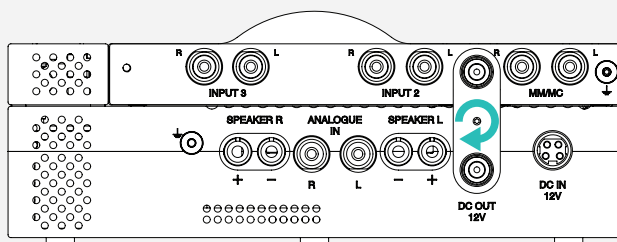

The respective power cables/supplies can now be attached and with all connections made as per section 4 Connections and Controls and the respective Suzi Pre manual, power to the units can be switched on, and the Suzi power amp power button depressed, to make the units ready for playback.

The Suzi Pre manual should be consulted for full operational guidelines.

5.3 The Suzi with the Hugo 2/USB multiplexer: DAC/amplifier

Adding the Hugo 2 and USB multiplexer transforms the Suzi power amp into a dual-input USB DAC/amplifier with USB-B data plus USB-C data and charging connections.

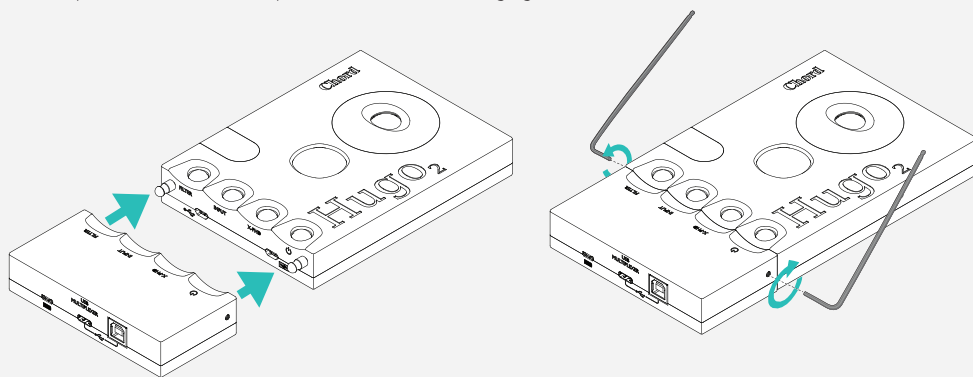

Attaching the USB multiplexer to the Hugo 2

Attach the two screw-in locking pins supplied with the Multiplexer to the Hugo 2, ensuring they are thumb-tight.

Place the Hugo 2 and the USB multiplexer on a flat surface and align. Carefully push the two units together ensuring that the Micro-USB connections are aligned throughout.

Attach the two screw-in hex bolts supplied to the USB multiplexer and carefully tighten with the supplied hex key, ensuring the bolts are not overtightened.

With power cables to the Suzi power amp disconnected, carefully place the Hugo 2/USB multiplexer atop the Suzi power amp, ensuring they are aligned, before gently sliding the units rightwards, to connect the Hugo 2's (female) outputs to the Suzi power amp's (male) inputs. (See 5.2 for a guide)

Charging bridge assembly

With the two units connected, secure them with the supplied charging bridge assembly, which provides charging power to the Hugo 2 when the Suzi power amp is powered off, along with a convenient high-current 5 V USB-C power output for ancillary devices. For constant charging, use the 5 V charger supplied with either the Hugo 2 or 2go.

Carefully attach the charging bridge assembly to the left faces of the Hugo 2/USB multiplexer, by aligning the Micro-USB sockets. This is best done on a flat surface. The charging bridge assembly can then be secured with the supplied hex bolt and key, taking care not to overtighten.

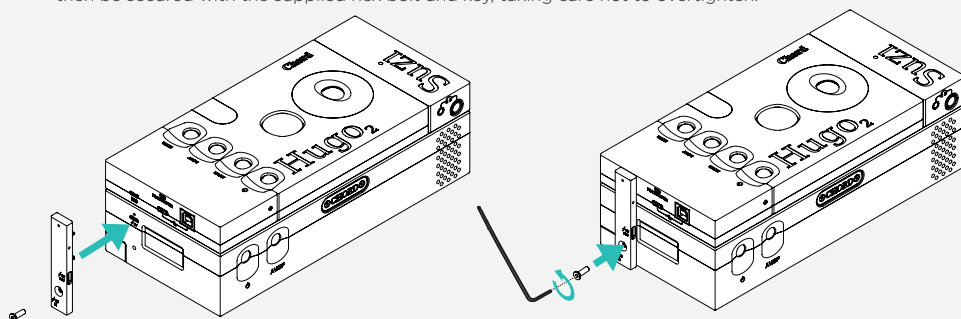

The USB Multiplexer offers both USB-B (data only) plus USB-C (data and charging) connections to the Hugo 2 DAC. Both connections can be made simultaneously and the Hugo 2 will auto-detect the signal for playback providing USB is selected as an input via the Hugo 2; see the Hugo 2 manual for operation information.

With the units secured, the Suzi power amp power supply cable can now be attached. With all cables and connections made as per section 4 Connections and Controls, power to the Suzi power amp can be switched on and the Suzi power amp and Hugo 2 power buttons depressed to make the units ready for playback.

The Hugo 2 manual should be consulted for operational guidelines in this configuration. The AV bypass button on the Suzi should be disengaged (blue) for this use case.

5.4 The Suzi with the Hugo 2 and the 2go streamer/player

Adding the Hugo 2 and the 2go transforms the Suzi power amp into a highly flexible streaming amplifier with Wi-Fi and Ethernet connectivity, plus library storage and playback from the 2go's twin 1 TB microSD card slots.

Attaching the 2go to the Hugo 2

This is best done on a flat surface. Attach the two screw-in locking pins supplied with the 2go to the Hugo 2, ensuring they are thumb-tight.

Place the Hugo 2 and 2go on a flat surface and align. Carefully push the two units together ensuring that the Micro-USB connections are aligned throughout.

Attach the two screw-in hex bolts supplied to the 2go, and carefully tighten with the supplied hex key, ensuring the bolts are not overtightened.

With power cables to the Suzi power amp disconnected, carefully place the Hugo 2/2go atop the Suzi power amp, ensuring they are aligned, before gently sliding the units rightwards, to connect the Hugo 2's (female) outputs to the Suzi power amp's (male) inputs. (See 5.2 for a guide).

With units secured, the Suzi power amp power supply cable can now be attached. With all cables and connections to the loudspeakers made, power to the unit can be switched on and the Suzi power amp and Hugo 2 power buttons depressed to make the units ready for playback.

The Hugo 2 and 2go manuals should be consulted respectively for operational guidelines in this configuration.

Charging bridge assembly

Refer to section 5.3 for charging bridge assembly.

5.5 Headphone operation

The Suzi power amp offers a headphone output from connected sources via its 1x 3.5 mm; 1x 6.35 mm (1/4 inch) headphone connections, which can be used simultaneously so two can listen. When connecting headphones, **please ensure the volume on partnering equipment is set to zero before slowly increasing to a comfortable level.**

5.6 AV bypass feature

The Suzi power amp is equipped with an AV bypass feature engaging the RCA inputs on the back, allowing the connection of any preamplifier.

To connect the Suzi power amp for AV bypass operation, connect to sources with a volume control using the device's RCA inputs, as outlined in the annotated drawings in section 4, Connections and controls.

To enable/disable the AV bypass function, press the AV/BP button sequentially: the button light will alternate between blue (off) and red (on/warning AV/BP mode enabled). The rear RCA inputs are engaged when ON.

5.7 Ground terminal

If hum occurs, use the back-panel ground terminal to connect to an available earth point.

6 Technical specifications

Please go to our website for the most recent specifications: www.chordelectronics.co.uk

Dimensions	Length 215 mm, Width 100 mm Height 69 mm
Weight	Suzi power amp - 2380 g
	Suzi power amp, Hugo 2 & USB adapter - 1909 g
	Suzi power amp, Hugo 2 & 2go - 1968 g
	Suzi power amp & Suzi pre - 2015 g
Power output	30 W into 8 Ω
THD	0.01 %
Signal-to-noise ratio	116 dB
Input maximum voltage	3 V RMS
Crosstalk	-97 dB
Output maximum voltage	15 V RMS into 8 Ω
Operation voltage	80-250 V AC auto-switching



Chord Electronics Ltd.

